



Mada Trade co.

# TILE LEVELLING SYSTEMS AND SPACERS

For quick and perfect installation of all types  
of ceramic and stone tiles





Mada Trade co.

# SOLO

## TILE LEVELLING SYSTEMS AND SPACERS



# SOLO

## TILE LEVELLING SYSTEMS AND SPACERS

### Clips and Wedges

#### Clips for Ceramic

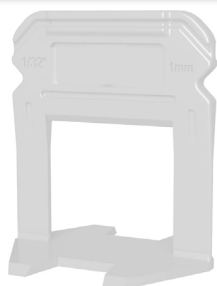

**0.5, 1.0, 2.0, 3.0 mm**

Clips are made of high-quality material, which allows clips to be highly resistant to traction so that heavy pieces can be adjusted fast and effectively.

Clips have side cuts, which allow us to remove them easily, just with a knock on the side in the joint direction, when the work is finished (mortar setting).

#### Clips for Stone



Stone clips are particularly designed for granite, stone and marble. Allow us to work between 16 and 30 mm. More resistant than the usual crosshead in order to adjust heavy formats. Between 16 and 20 mm, use it together with the special wedge-base to ensure tightening. Use the same wedge as for the ceramic's crosshead.

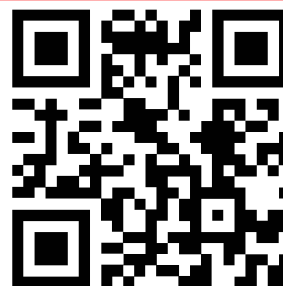

# SOLO

## TILE LEVELLING SYSTEMS AND SPACERS

### Clips and Wedges

#### Wedges

Wedges have saw-shaped teeth to be adjusted to the crosshead precisely and achieve top efficiency. The wedge base is round not to damage ceramics. Wedges can be reused.





# SOLO

## TILE LEVELLING SYSTEMS AND SPACERS

### Clips and Wedges

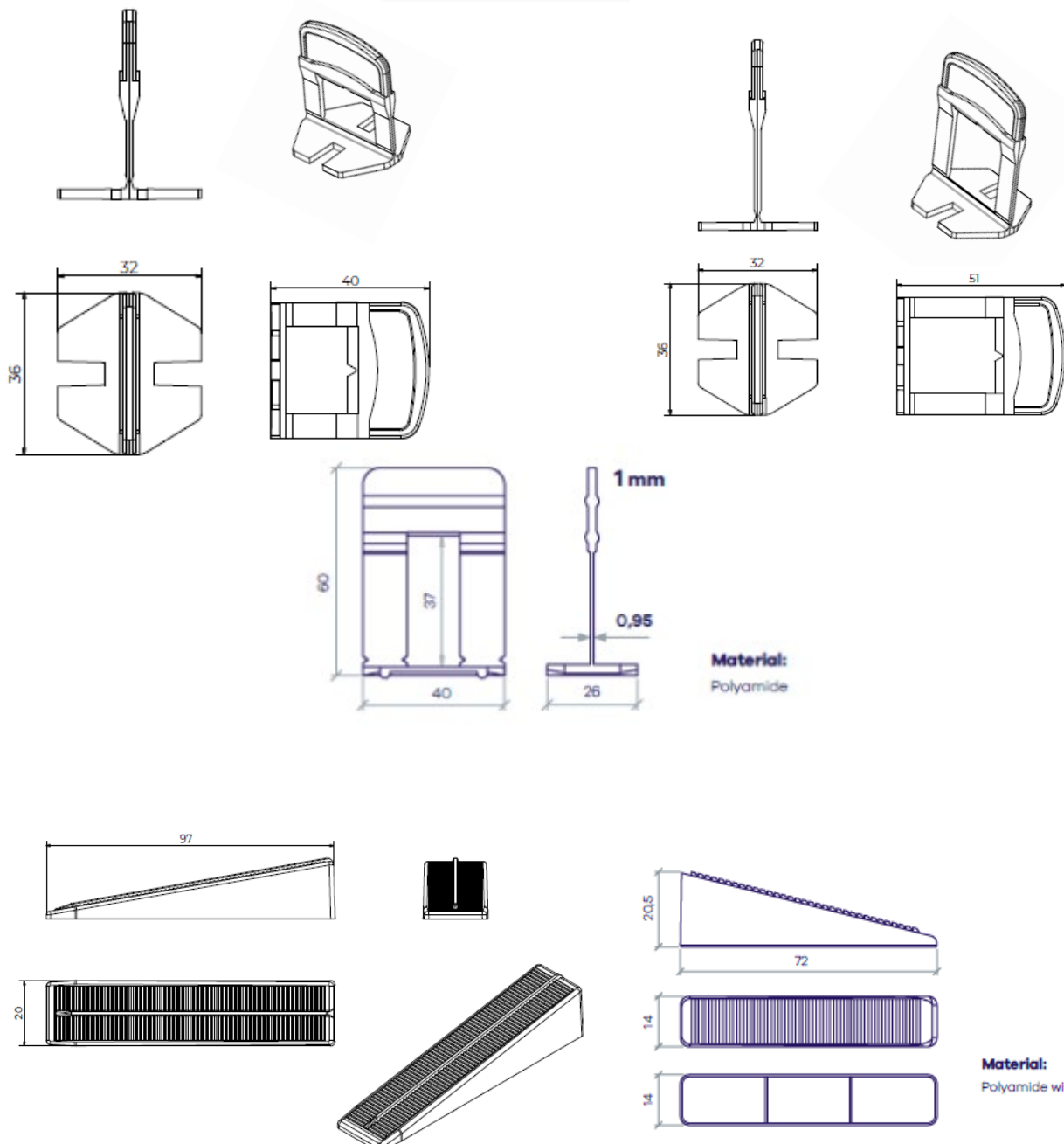



# SOLO

## TILE LEVELLING SYSTEMS AND SPACERS

### Clips and Wedges

Description	mm	Units	Bags	Box	Weight	Pallte
			Per Box	cm	Kg	no. / box
Clip	0.50	100	30	59x39x41	16.5	20
Clip	1.00	100	30	59x39x41	16.5	20
Clip	1.50	100	30	59x39x41	16.5	20
Clip	2.00	100	30	59x39x41	16.5	20
Clip	3.00	100	30	59x39x41	16.5	20
Clip for Stone	1.00	80	30	46x40x39	12.5	20
Levelling Wedge		100	37	59x39x41	24.9	20



# SOLO

## TILE LEVELLING SYSTEMS AND SPACERS

### Tile spacers

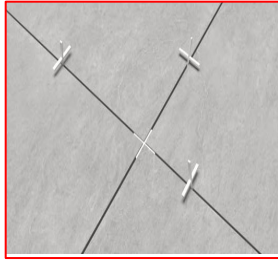

							PACKING		
Code	ARTICLE	mm (in)	+	mm	Pcs				
0801601	Tile Spacer	1 (1/32")	31	2,6	300	170	59x39x41	10,18	
0801602	Tile Spacer	1,5 (1/16")	31	3	300	150	59x39x41	9,80	
0801603	Tile Spacer	2 (3/32")	31	3,5	300	140	59x39x41	15,28	
0801604	Tile Spacer	3 (1/8")	31	3,5	300	120	59x39x41	16,3	
0801605	Tile Spacer	4 (5/32")	31	4	200	80	59x39x41	12,00	
0801606	Tile Spacer	5 (3/16")	33	5	150	120	59x39x41	17,20	
0801607	Tile Spacer	6 (1/4")	33	6	100	100	59x39x41	11,00	
0801608	Tile Spacer	7 (9/32")	44	7	50	120	59x39x41	10,20	
0801609	Tile Spacer	8 (5/16")	44	8	50	100	59x39x41	12,00	
08016010	Tile Spacer	10 (13/32")	45	10	45	90	59x39x41	12,90	

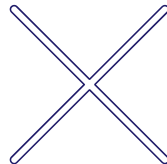
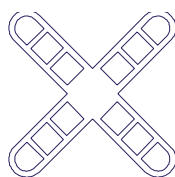



# SOLO

## TILE LEVELLING SYSTEMS AND SPACERS

### T -Tile spacers

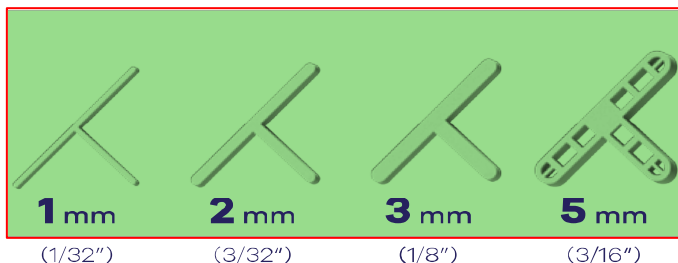

1 mm

(1/32")

2 mm

(3/32")





3 mm

(1/8")

5 mm

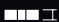
(3/16")

### Packing

Code	Articale	mm (in)			Pcs			
0816011	T Tile Spacer	1 (1/32")	31	2,6	300	240	59x39x41	10,20
0816012	T Tile Spacer	2 (3/32")	31	3,5	300	220	59x39x41	14,00
0816013	T Tile Spacer	3 (1/8")	31	3,5	300	200	59x39x41	21,00
0816014	T Tile Spacer	5 (3/16")	33	5	200	90	59x39x41	10,60



# SOLO

## TILE LEVELLING SYSTEMS AND SPACERS

### PUSH & LEVEL SYSTEM

#### HOW DO YOU USE IT?

1. INSERT THE CROSSHEAD AND PRESS THE PUSH UNTIL IT COMES INTO CONTACT WITH THE FLOOR TILE.
2. LEVEL OUT BY MAKING A SMALL CIRCULAR MOVEMENT.
3. ALWAYS BREAK IN THE DIRECTION OF THE TILE JOINT.
4. REUSE THE BELLOTA PUSH SYSTEM.

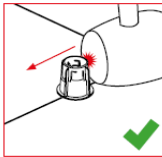
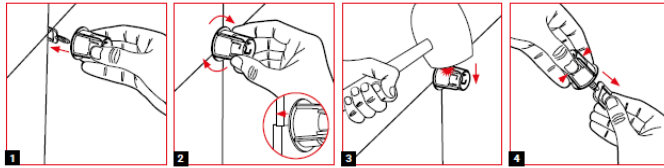

**HOW TO  
BREAK**



Push

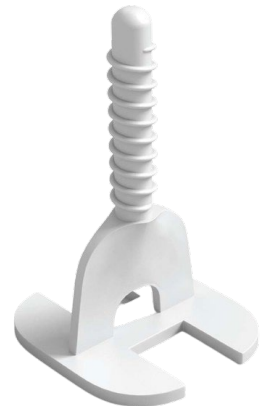

Cross head

Code	Description		Tile mm	Pcs. / bag	box/bags
08016015	Corsshead	0.5 mm	6-13	200	100
08016016	Corsshead	1.0 mm	6-13	200	100
0816016	Corsshead	2.0 mm	6-13	200	100
0816017	Corsshead	3.0 mm	6-13	200	100
08016018	Corsshead	1.0 mm	13-20	200	100
0816019	Push			100	500

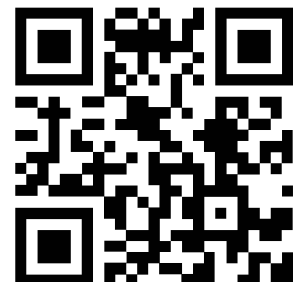

# SOLO

## TILE LEVELLING SYSTEMS AND SPACERS





El-Thagr complex – bld. 2, apt.105, El-Nozha airport  
road next to Talaat ,Mustafa hospital , 5431001 .  
Alexandria, Egypt.

Tel: +20 3 3832405 , +20 3 3832406 Fax: +20 3 3808003

E-mail: [info@mada-trade.com](mailto:info@mada-trade.com)

<https://www.mada-trade.com/>

